



Tribeca

ROBERT ALLEN  WINDOWS

Tribeca



BALL FINIAL
1.75"L 1.25"H



CYLINDER FINIAL
.75"L 1"H



BLOCK FINIAL
.75"L 1"H



DOMES FINIAL
small .5"L .75"H large .75"L 1"H



FLARE FINIAL
1.5"L 1.25"H



ELIPSE FINIAL
1"L 1.75"H



Silhouette Inside Mount with wire and Silhouette Rings
fabric: Sheer Satin aqua



CURVED EXTENDED BRACKET .625" (5/16")
5.5" projection



SILHOUETTE INSIDE MOUNT
(3.5" projection) with wire



SILHOUETTE STANDARD BRACKET
(3.5" projection) with wire and
SILHOUETTE RINGS (1" diameter)



STANDARD BRACKET LONG .5"
(4.5" projection); STANDARD BRACKET
SHORT .75" (2.75" projection)



RING W/CLIP (large) and RING (large)
1" diameter



BRASS



COPPER



STAINLESS

HARDWARE FEATURES

- seven finial choices
- all hardware is available in all finishes:
Brass, Copper, Stainless
- the .5", .625" ($\frac{5}{8}$ ") and .75" rods are available in 4' and 8' lengths
- a bracket support is recommended in the center of any 8' (or longer) rod length, and at the combination point whenever two rods are joined for single layer treatments. For double layer treatments a bracket support is recommended every 6'.
- the elbow is flexible; it is intended to allow for rod connection at any angle
- the curved bracket allows for a simple rod without a finial
- all items are shown in the Stainless finish
- tiebacks are created by combining the finials with the tieback posts

This collection is exclusive to Robert Allen.

COVER PHOTO

finial: Elipse copper
rod: .75" copper
drape: Valobra canyon
the butternut wood paneling used in this photo is an example of an ecologically responsible forest product and sustainable forest management.

INSIDE COVER PHOTO

finial: Flair stainless
rod: .75" stainless
bracket: Standard short stainless
clip: blind mount
ring: large w/ clip
fabric: Bardolino pebble

Tribeca

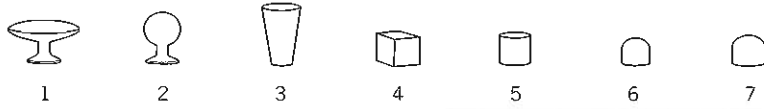

FINIALS

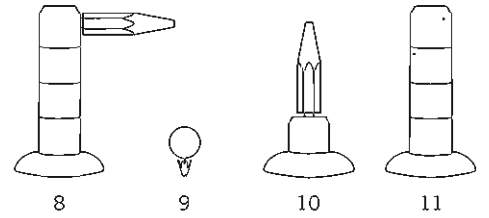

WIRE SYSTEM

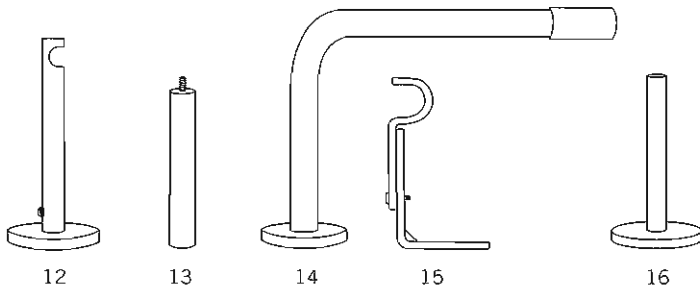

BRACKETS

TIEBACK

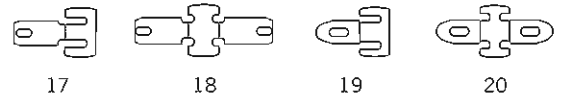

CLIPS

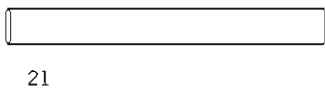

ROD

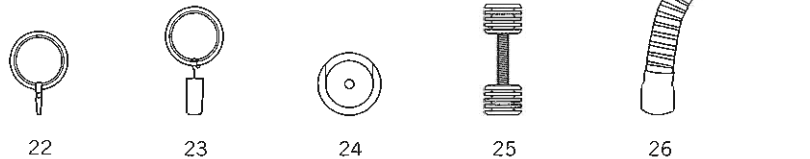

OTHER

FINIALS

- 1 Ellipse finial (1"L 1.75"H)
- 2 Ball finial (1.75"L 1.25"H)
- 3 Flare finial (1.5"L 1.25"H)
- 4 Block finial (.75"L 1"H)
- 5 Cylinder finial (.75"L 1"H)
- 6 Dome (small) finial (.5"L .75"H)
- 7 Dome (large) finial (.75"L 1"H)

All finials should be used with the .75" rod with the exception of the Dome-small designed for the .5" rod.

WIRE SYSTEM

- 8 Silhouette standard bracket (3.5" projection) comes with 10' of wire
- 9 Silhouette ring (1" diameter)
- 10 Silhouette inside mount (3.5" projection) comes with 10' of wire
- 11 Silhouette center support (3.5" projection)

BRACKETS

- 12 Bracket (short and long standard brackets are available for .5" and .75" rods; short projection is 2.75", long projection is 4.5")
- 13 4" Extender (extends the short and long standard brackets to create 6.75" and 8.5" extensions)
- 14 Curved bracket (available for .625" [5/8"] rod only; standard bracket projects 3.5"; extended bracket projects 5.5")
- 15 Center support (available for .625" [5/8"] rod only; projection range is 4" to 5.5")

TIEBACKS

- 16 Tieback post (combine with finials to create matching tiebacks)

CLIPS

- 17 Rod clip (clips one rod to bracket)
- 18 Rod butterfly clip (clips two rods to bracket, on either side of the post)
- 19 Blind clip (clips a blind or traverse rod to bracket)
- 20 Blind butterfly clip (clips a blind or traverse rod below bracket, on either side of the post)

The Rod Mount Set includes two rod clips and one butterfly clip.
The Blind Mount Set includes two blind clips and one blind butterfly clip.

ROD

- 21 Rod (.5", .75" and .625" [5/8"] rods available in 4' and 8' lengths)

OTHER

- 22 Ring (available in small and large; small diameter is .75", large diameter is 1")
- 23 Ring with clip (available in small and large; small diameter is .75", large diameter is 1")
- 24 Inside mount (available in small and large; use small for .5" and .625" [5/8"] rod, use large for .75" rod)
- 25 Connector (available for .5", .625" [5/8"] and .75" rods)
- 26 Elbow, a flexible connector for angled installations (available for .5" and .75" rods. .75" elbow is 6" long, .5" elbow is 5" long)

ROBERT ALLEN  WINDOWS

For customer service in the United States call 1.800.333.3777,
in Canada 1.800.363.3020, in Europe +44 (0) 1494.603444.

© 2002 THE ROBERT ALLEN GROUP, INC.